

A  
B  
C  
D  
E  
F  
G  
H

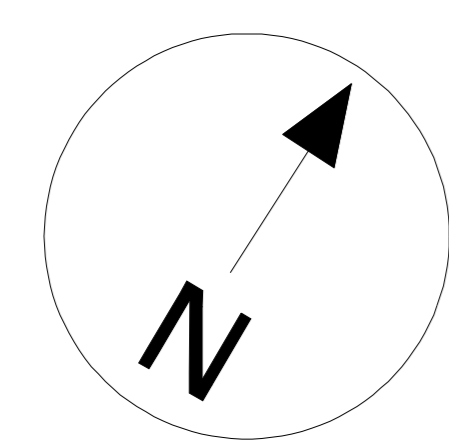

- LEGEND**
- NEW EQUIPMENT
  - EXISTING EQUIPMENT
  - APPLICATION BOUNDARY
  - WORKS PREVIOUSLY GRANTED UNDER PLANNING PERMISSION NO 10-3
  - - - EQUIPMENT TO BE REMOVED
  - + EXISTING LEVELS

ASSOCIATED DRAWINGS:  
 PE492-D015-002-001 SECTION THROUGH LINE BAY H5  
 PE492-D015-029-001 KILKENNY MASTER LAYOUT OF STATION

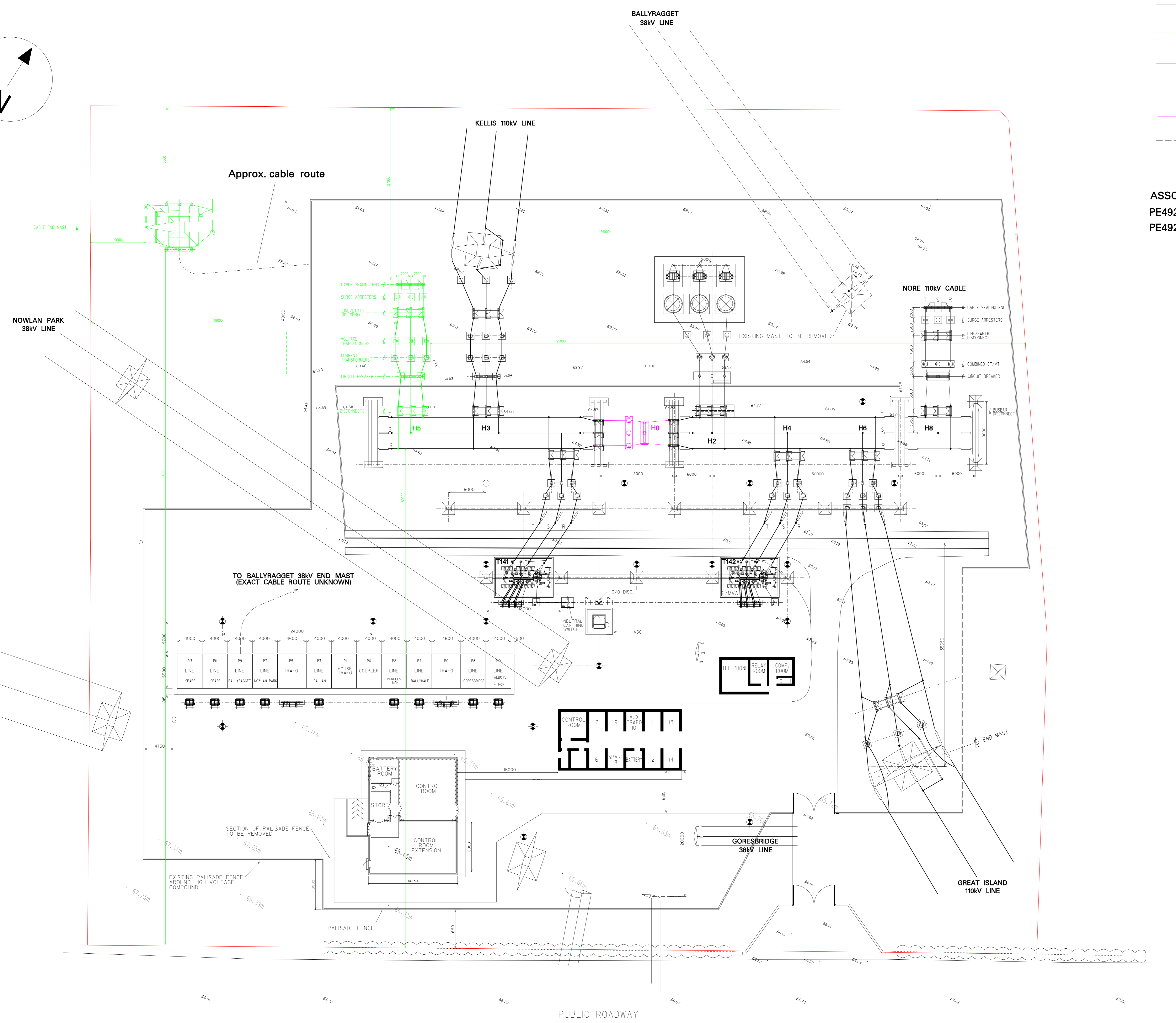

2	1212	Property boundary changed to not showing and construction changed. Reference to planning application 10-3 added.	SW	SW	PD	CT
1	012	Cable end mast added.	SW	SW	PD	CT
REV	DATE	REVISION DESCRIPTION	DRN	PROJ	VER	APP

PURPOSE OF ISSUE - PRELIMINARY UNLESS INDICATED  
 TENDER  CLIENT APPROVAL  CONSTRUCTION  AS-BUILT  REVISED

Client: **EIRGRID**

Project: **Kilkenny 110kV Substation**

Contract:

Drawing Title: **KILKENNY 110kV SUBSTATION SITE LAYOUT PLAN FOR NEW LINE BAY H5 FOR PLANNING PERMISSION**

Production Unit: **High Voltage Engineering**

**ESB International**  
 ESB Energy Innovation  
 ESB Engineering Solutions, Shelton Court, 18-21 St. Stephen's Green, Dublin 2, Ireland. Tel: (01) 703 8000 Fax: (01) 703 7185 Email: [enquiries@esbi.ie](mailto:enquiries@esbi.ie) Web: [www.esbi.ie](http://www.esbi.ie)  
 ESB Engineering Solutions is a trading name of ESB Engineering & Facility Management Limited. Registered Office in Dublin. Registered in Ireland No. 10094

DRAWN	PRODUCED	VERIFIED	APPROVED	APPROX DATE
ELKot	JAsh	PDuff	CTaomey	04/02/12
CLIENT REF	TC207904	No. of SHEETS	SIZE	SCALE
		-	A0	1:250

DRAWING NUMBER: **PE492-D015-173-001-002**

COPYRIGHT-ESB INTERNATIONAL LIMITED. All rights reserved. No part of this work may be modified or reproduced or copied in any form by any means, graphic, electronic or mechanical, including photocopying, recording, taping or information retrieval systems, except for any purpose other than to design and produce, without the written permission of ESB International Limited.